

TECHNICAL DATA SHEET

LED Track Light / EN-TLL035-01

VERSION - 01.09.2017

STANDARD LUMINAIRE

Reference	EN-TLL035-01
Power	35 W
Current	730 mA
Protection Class	IP20
Dimensions	3-pin track: $\varnothing 93 \times 164 \times \text{Ht.} 204\text{mm}$ 4-pin track: $\varnothing 93 \times 164.1 \times \text{Ht.} 199.3\text{mm}$
Voltage	AC220-240V, 50-60Hz
Led Type	Cree Cob Led
CRI	80+ OR 90+
Beam Angle	10°, 18°, 30°, 38°
Dimmable	YES
Installation	Track or Surface-Mounted
Working T°	-20°C ~ +45°C
Warranty	5 years

FINISH

Standard	White, Black
----------	--------------

ON REQUEST

CRI	80+, 90+
Beam Angle	10°, 18°, 30° or 38°
Installation Type	On 3-pin track On 4-pin track Surface-Mounted
Dimming Option	Triac, 1-10V, DALI <i>Ask technical departement for more information</i>

COLOR TEMPERATURE & LUMINOUS FLUX

EN-TLL035-01

2'700K	3'000K	4'000K	5'000K
2520 lm $\pm 5\%$	2765 lm $\pm 5\%$	2905 lm $\pm 5\%$	2963 lm $\pm 5\%$

CERTIFICAT

CE

MAIN FEATURES:

- Dual cylindar design and attractive outlook
- Beam angle can be changed easily by replacing reflectors without any tool.
- Track head rotates through 355° and pivots though 180°

APPLICATION:

- For museums, exhibitions, art galleries, sales and showroom areas.



TECHNICAL DRAWINGS

3-pin track

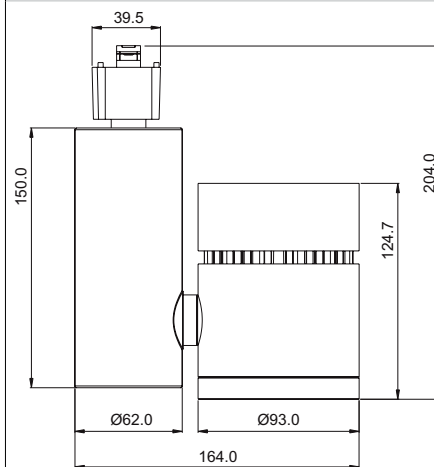

4-pin track

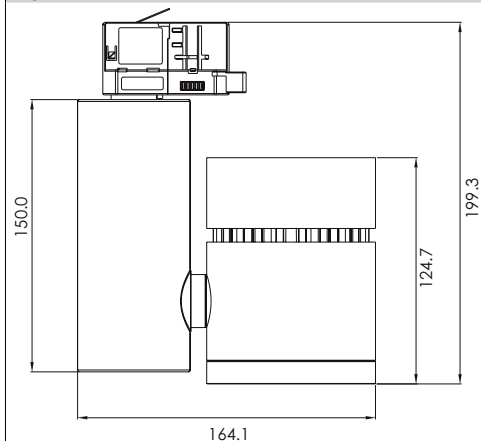

AGABEKOV



AGABEKOV SA Manufacture 6, ROUTE DE COMPOIS
CH-1222 VÉSENAZ - GENEVA - SWITZERLAND
Tel. +41 22 752 47 45 Fax. +41 22 752 37 08
E - mail: info@agabekov.com



AGABEKOV SA Bureau d'etudes 6, ROUTE DE COMPOIS
CH-1222 VÉSENAZ - GENEVA - SWITZERLAND
Tel. +41 22 752 47 45 Fax. +41 22 752 37 08
Internet: www.agabekov.com

